



## DOWNTOWN DEVELOPMENT AUTHORITY

City Hall, 125 South Maple Street, Fennville, MI 49408  
Wednesday, May 6, 2020  
7:00 p.m.

---

In light of the recent orders to limit social interactions due to COVID-19, the Downtown Development Authority will allow for participation through a virtual meeting site of by telephone. To access the meeting visit:

Join Zoom Meeting

Meeting ID: 828 2410 8599

<https://us02web.zoom.us/j/82824108599>

One tap mobile

+13126266799,,82824108599# US (Chicago)

Dial by your location

+1 312 626 6799 US (Chicago)

As always, citizens can also submit their comments in writing by 6:30 p.m. by:

Email to [amorgan@fennville.com](mailto:amorgan@fennville.com)

Drop Box located on the parking lot side of City Hall

By mail to PO Box 666, Fennville, MI 49408

### AGENDA

1. Call to Order
2. Roll Call
3. Pledge of Allegiance
4. Public Comments
5. Approval of DDA Minutes
  - a. [March 4, 2020](#) – Click link to view draft minutes
6. Treasurer Report
  - a. Treasurer Reports
  - b. Invoices

### NEW BUSINESS

7. The DDA will be asked to review a quote from JR Electric to install photocell to operate the lights at the 220 Building.
8. The DDA will be asked to review and discuss preliminary estimates for paving the downtown parking and installing a crosswalk from MDOT.

**9. The DDA will be asked to discuss additional items for downtown including: hand washing stations, picnic tables, and additional waste receptacles.**

**10. The DDA will discuss the possibility of offering a grant program to downtown businesses to provide relieve from COVID19.**

**11. Committee Reports:**

- a. Economic Development**
- b. Marketing and Promotion**
- c. Physical Elements**
- d. Goose Festival**
- e. City Commission**

**12. Miscellaneous**

**13. Adjournment**

- Next Meeting is June 3, 2020

JR Electric, LLC

3298 Oak Ridge Circle  
Hamilton, MI 49419

# Estimate

Date	Estimate #
3/30/2020	201

Name / Address
CITY OF FENNVILLE 222 SOUTH MAPLE FENNVILLE, MI 49408

Project

Description	Qty	Rate	Total
Electrical Quote for Porch Lights @ Michigan Works Building Install Photo Cell & Rewire 2 Porch Lights to Operate Dusk to Dawn Labor and Material (Permit not included)		275.00	275.00
Thanks for the opportunity to quote.		<b>Total</b>	\$275.00

JN128067 Estimate for local parking participation.

Comments added by Prein&Newhof  
5/04/20  
2190141/DNC

JN	(All)
Category	(All)
Work Item	(All)
Table - Type	(All)
Table - Name	(All)

How was 16% determined? Can it be reduced?

Item No	Pay Item Name	Units	Unit Price	Data	
				Quantity	Grand Total
1500001	Mobilization, Max	LSUM	80000	0.16	\$12,800.00
2090001	Project Cleanup	LSUM	2000	0.16	\$320.00
4030005	Dr Structure Cover, Adj, Case 1	Ea	428.66	1	\$428.66
4030390	Dr Structure, Temp Lowering	Ea	236.14	1	\$236.14
5010001	Pavt, Cleaning	LSUM	2000	0.16	\$320.00
5010002	Cold Milling HMA Surface	Syd	1.6	843	\$1,348.80
5010007	HMA Quality Initiative	Dir	1	346	\$346.00
5010061	HMA Approach	Ton	106.22	173	\$18,376.06
8110204	Pavt Mrkg, Preformed Thermoplastic, Accessible Sym	Ea	347.28	2	\$694.56
8110293	Pavt Mrkg, Waterborne, for Rest Areas, Parks, & Lots, 4	Ft	1.14	76	\$86.64
8110294	Pavt Mrkg, Waterborne, for Rest Areas, Parks, & Lots, 4	Ft	1.32	1128	\$1,488.96
<b>Grand Total</b>				<b>2570.48</b>	<b>\$36,445.82</b>

Would an alternative approach to getting this work done be for the City to hire a local paver outside of MDOT M89 project scope and just coordinate during construction?

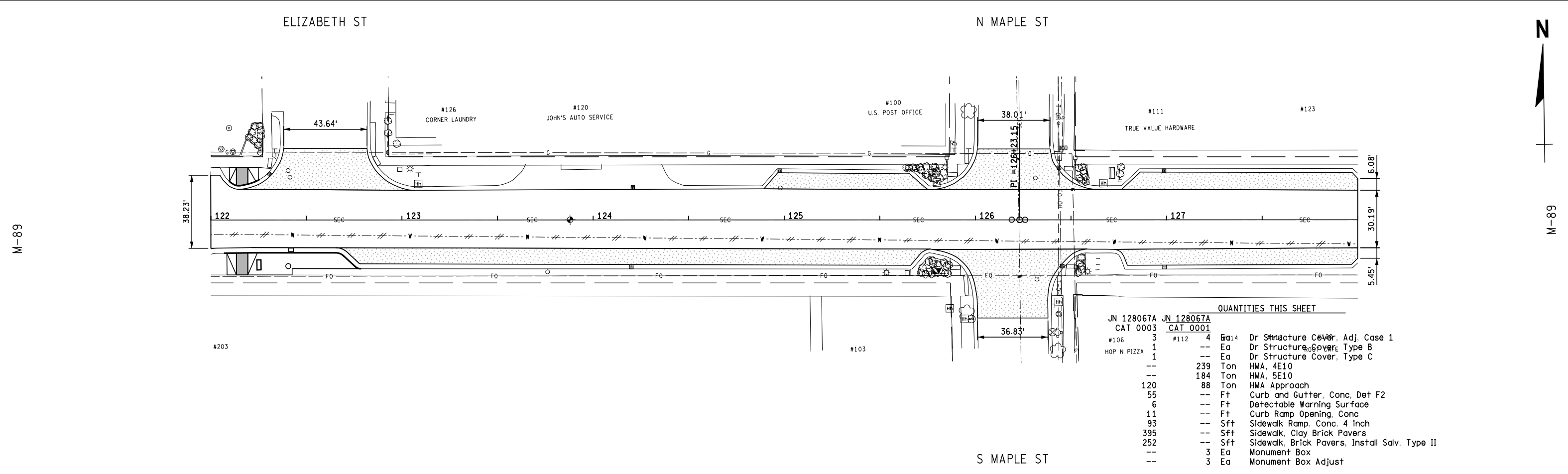
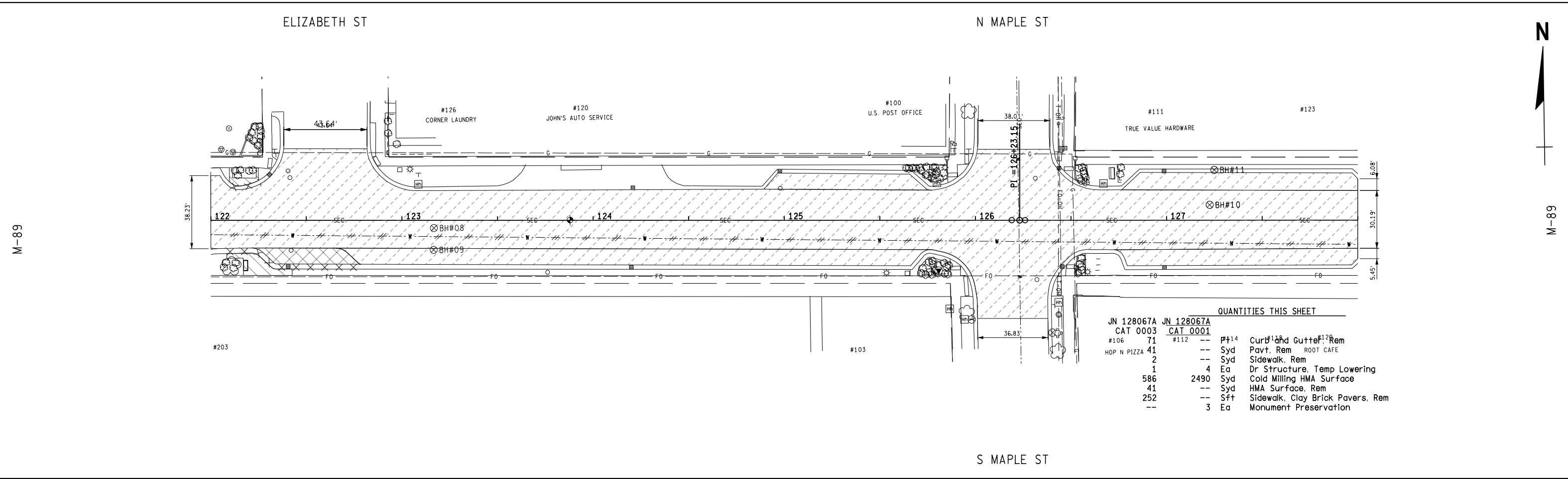

FINAL ROW PLAN REVISIONS (SUBMITTAL DATE: )								DATE: 03/17/20		CS: 3021		REMOVAL/CONSTRUCTION		DRAWING SHEET	
NO.	DATE	AUTH	DESCRIPTION	NO.	DATE	AUTH	DESCRIPTION	DESIGN UNIT: JASINSKI	JN: 128067A	M-89 STA 122+00 TO STA 128+00		M-89	SECT 1		
								TSC: GRAND RAPIDS				REM/CON	6		

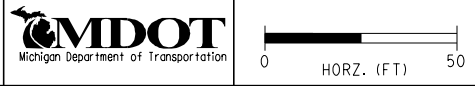

FILE: 128067\_REM\_006.dgn

JN128067 Estimate for local ADA crossing participation.

JN	(All)
Category	(All)
Work Item	(All)
Table - Type	(All)
Table - Name	(All)

Item No	Pay Item Name	Units	Unit Price	Data	
				Quantity	Grand Total
2040020	Curb and Gutter, Rem	Ft	7.31	71	\$519.01
2040050	Pavt, Rem	Syd	20.77	41	\$851.57
2040055	Sidewalk, Rem	Syd	7.95	2	\$15.90
2047051	Rem Misc Site Items	LSUM	5000	1	\$5,000.00
4030005	Dr Structure Cover, Adj, Case 1	Ea	428.66	2	\$857.32
4030010	Dr Structure Cover, Type B	Ea	570	1	\$570.00
4030015	Dr Structure Cover, Type C	Ea	780	1	\$780.00
5010005	HMA Surface, Rem	Syd	13.05	41	\$535.05
8020036	Curb and Gutter, Conc, Det F2	Ft	29.75	55	\$1,636.25
8030010	Detectable Warning Surface	Ft	34.38	6	\$206.28
8030030	Curb Ramp Opening, Conc	Ft	23.96	11	\$263.56
8030034	Sidewalk Ramp, Conc, 4 inch	Sft	5.9	93	\$548.70
8030050	Sidewalk, Clay Brick Pavers	Sft	20.96	395	\$8,279.20
8030051	Sidewalk, Clay Brick Pavers, Rem	Sft	8.1	252	\$2,041.20
8037010	Sidewalk, Brick Pavers, Install Salv, Type II	Sft	17.79	252	\$4,483.08
8157050	Bench Salv, Reinstall	Ea	1250	1	\$1,250.00
<b>Grand Total</b>				<b>1225</b>	<b>\$27,837.12</b>